



# LIGHTING & ACCESSORIES

## Surface Sockets



Data Specification **2025**



**AUSTRALIA WIDE DELIVERY**  
Expedited delivery to all states in Australia



**SAME DAY DISPATCH**  
Orders prior to 12PM will be dispatched the same day



**5 YEAR WARRANTY**  
You can get a trusted 5 Year In House Warranty with CSG

## [ DESCRIPTION ]

## PLUG BASES

Surface mount sockets offer a convenient way of providing power in many applications. They feature a nail plate for an easy to wire connection. Available in a variety of configurations in both single and double outlets, deep base and quick fit type. They are made from polycarbonate material and are rated 250V AC 10A-15A

## [ FEATURES ]

- Back Wired
- Clip On Clear Base
- Loop Terminal
- Available with Deep Base
- Available in 3 and 4 Pin
- Available in Red

## [ TECHNICAL PARAMETERS ]

- Rated Voltage: 250V AC
- Rated Frequency: 50/60Hz
- Material: Polycarbonate
- Complies with Standard:  
AS/NZS 3100:2017+A1-4  
AS/NZS 3112:2017+A1-3

## [ APPROVALS ]

SAA Approved

## [ IMAGES ]



SMS1R



SMS1T



SMS1RT



SMS1M



SMS14



SMS2



SMS1QC

## [ DESCRIPTION ]

## QUICK FIT

The world's first toolless plug base, available in two models for either 1mm<sup>2</sup> Solid Core 2C+E Cable or stranded 1.5mm<sup>2</sup> to 2.5mm<sup>2</sup> 2C+E Cable. Terminates in 4 seconds without the need to strip insulation or use any tools. 22 times faster to wire than any other plug base on the market today. Rated at 250V AC 10amp. Patented technology and available in black and white.

## [ FEATURES ]

- No Tools Required
- No Stripping of Insulation
- SMS1\_IQF suits 1mm<sup>2</sup> Solid Core 2C+E
- SMS1QF suits 1.5mm<sup>2</sup> - 2.5mm<sup>2</sup> 2C+E
- Cable Guide with Wire Identification
- Optional Purlin Mounting Clip
- Optional Purlin Cable Clip

## [ TECHNICAL PARAMETERS ]

- Rated Voltage: 250V AC
- Rated Frequency: 50/60Hz
- Rated Amperage: 10A
- Complies with Standards:  
AS/NZS 3112:2009  
AS/NZS 3100:2009  
AS/NZS 60998.2.3:2012  
AS/NZS 60998.1:2012

## [ APPROVALS ]

SAA Approved

## [ IMAGES ]



SMS1QF

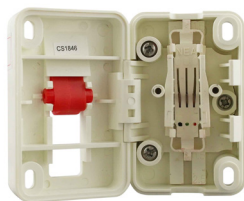

SMS1QF Inside



SMS1\_IQF

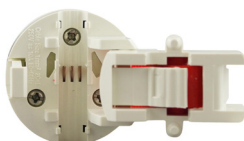

SMS1\_IQF Top View



Watch how simple it is to install SMS1QF



Watch how simple it is to install SMS1\_IQF



## [ SPECIFICATIONS ]

Product Code	Description	Rating (Amps)	Voltage (V)	Colour
SMS1	Surface Mount Socket Single	10A	250V	WHITE
SMS2	Surface Mount Socket Double	10A	250V	WHITE
SMS1M	Surface Mount Socket Single Mini 55mm	10A	250V	WHITE
SMS1R	Surface Mount Socket Single ROUND EARTH	10A	250V	WHITE
SMS1T	Surface Mount Socket Single TRADE	10A	250V	WHITE
SMS1T-15	Surface Mount Socket Single TRADE	15A	250V	WHITE
SMS1RT	Surface Mount Socket Single TRADE	10A	250V	RED
SMS14	Surface Mount Socket Single 4 Pin 2 Actives DEEP BASE	10A	250V/500V	WHITE
SMS14F	Surface Mount Socket Single 4 Pin FLAT 2 Actives DEEP BASE	10A	250V/500V	WHITE
SMS1R4	Surface Mount Socket Single 4 Pin 2 Actives DEEP BASE	10A	250V	RED
SMS1QC	Socket Surface Mount Single Quick Connect 1mm <sup>2</sup> - 2.5mm <sup>2</sup> 2C+E	10A	250V	WHITE
SMS1RQC	Socket Surface Mount Single Quick Connect 1mm <sup>2</sup> - 2.5mm <sup>2</sup> 2C+E	10A	250V	RED
SMS1QF	Surface Mount Socket Quick Fit 1.5mm <sup>2</sup> - 2.5mm <sup>2</sup> 2C+E	10A	250V	WHITE
SMS1BQF	Surface Mount Socket Quick Fit 1.5mm <sup>2</sup> - 2.5mm <sup>2</sup> 2C+E	10A	250V	BLACK
SMS1RQF	Surface Mount Socket Quick Fit 1.5mm <sup>2</sup> - 2.5mm <sup>2</sup> 2C+E	10A	250V	RED
SMS1_1QF	Surface Mount Socket Quick Fit 1mm <sup>2</sup> 2C+E Solid Core	10A	250V	WHITE
SMS1QF-GT	Grommet to suit SMS1QF and SMS1BQF	-	-	RED
SMS1QFCL	Purlin Mount Clip to Suit SMS1QF and SMS1BQF	-	-	WHITE
CL25	Cable Clip 2C+E 2.5mm	-	-	WHITE

## [ WARRANTY ]

Connected Switchgear mechanisms come with a trust 5 Year In House Warranty.\* That means that you have peace of mind knowing that if a fault develops within a five year period, Connected Group Australia will cover the cost of replacing the product and it's installation.\*\*

\* SMSIT has a 6 Month Replacement Only Warranty

\*\* See our website for full terms and conditions [www.connectedswitchgear.com.au](http://www.connectedswitchgear.com.au)

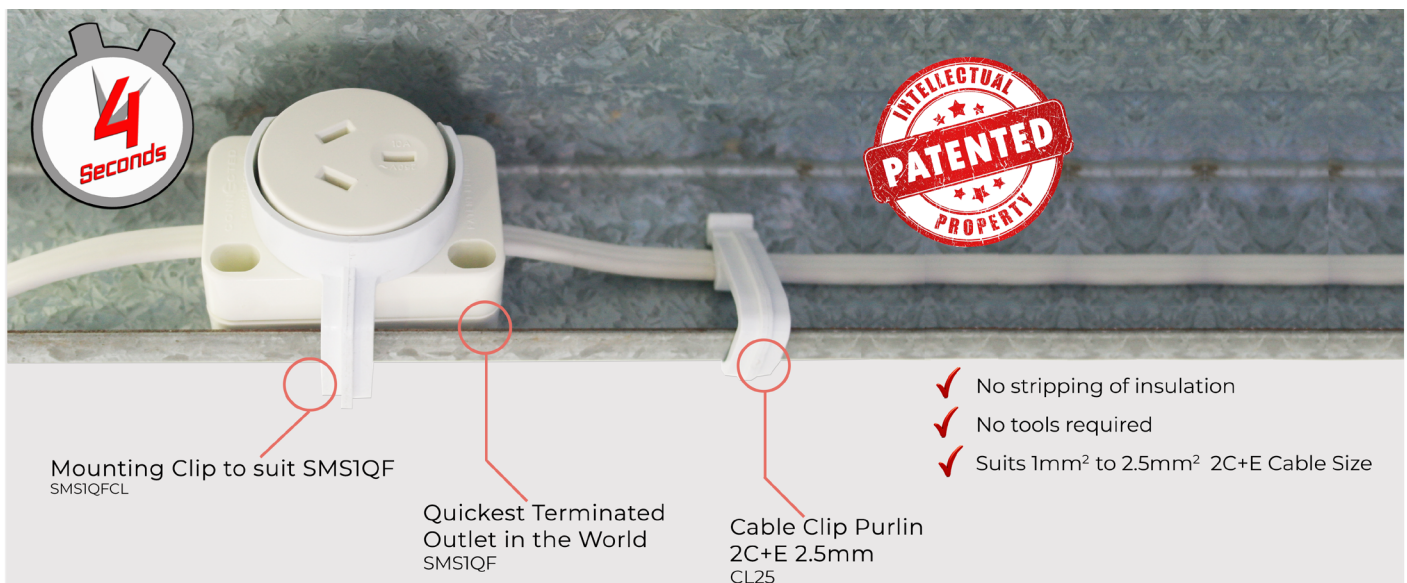

# LIGHTING & ACCESSORIES